

**CUMMINS C SERIES**



**Model:** P1722C 3922589  
**Fits:** 300, 350, 400 HP  
**Ports:** 2" In, 1-3/4" Out

**Shaft not included with 2110306.**

PART NO.	DESCRIPTION	PRICE
2110131	Pump w/Gear	\$1,514.75
2110300	* o Impeller	\$91.72
2110642	* End Cover	\$65.44
2110726	Cover Screws	\$2.21
2109945	* o Cover 'O' Ring	\$7.97
2110367	* o Key	\$9.80
2110571	* Cam	\$93.30
2110572	Cam Screw	\$9.02
2110641	* o Wear Plate	\$63.43
2110454	* Seal, Mech. 'C'	\$126.12
2110455	* o Mechanical Seal	\$49.34
2110849	Shaft & Bearing Ass.	\$257.87
2110851	*(2) Bearings	\$15.60
2110674	* o Oil, Lip Seal	\$32.21
2110952	*(3)o Retaining Ring	\$11.46
2110759	* Flat Washer	\$2.83
2110772	*(2) Flat Washer	\$8.88
2109946	* O-Ring	\$3.40
2110305	o Minor Repair Kit	\$328.37
2110304	Minor Repair Kit 'C'	\$529.15
2110306	* Major Repair Kit	\$577.79
2110308	Major Repair Kit 'C'	\$729.43

\*Incl. in Major Repair Kit, o Included in Minor Repair Kit

**CUMMINS C SERIES**



**Model:** P1730C, 3866493  
**Fits:** 430 HP, 6 CTA 8.3L  
**Ports:** With no Port Elbows

**Shaft not Included with 2110306 major repair kit.**

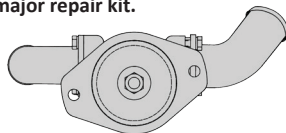

PART NO.	DESCRIPTION	PRICE
2110129	Pump w/Gear	\$1,000.90
2110300	* o Impeller	\$91.72
2110454	* Seal, Mech. "C"	\$126.12
2110455	* o Seal, Mech.	\$49.34
2110674	* o Lip Seal	\$32.21
2110851	* (2) Bearing	\$15.60
2110849	Shaft/Bearing Ass., Threaded	\$257.87
2110571	* Cam	\$93.30
2109945	* o Cover "O" Ring	\$7.97
2110572	Cam Screw	\$9.02
2110642	* End Cover	\$65.44
2110726	End Cover Screw	\$2.21
2110367	* o Key	\$9.80
2110952	*(3) o Retaining Ring	\$11.46
2110772	*(2) Flat Washer	\$8.88
2109946	* O-Ring	\$3.40
2110641	* o Wear Plate	\$63.43
2110759	* Flat Washer	\$2.83
2110305	o Minor Repair Kit	\$328.37
2110304	Minor Repair Kit "C"	\$529.15
2110306	* Major Repair Kit	\$577.79
2110308	Major Repair Kit "C"	\$729.43

\*Included in Major Repair Kit, o Included in Minor Repair Kit

**Please Note the Following**



**As of Oct. 2011, Sherwood pumps P1710, P1716, P1722, P1726, P1727, P1730 and P1732**

have been updated and now end in "C". All pumps prior to the change have the "Old" style shaft and bearing assembly and water seal. Installing the "New" style shaft and bearing assembly and water seal in an "Old" style pump converts it to the updated style. Shaft not included with 2112322.

**CUMMINS C SERIES**

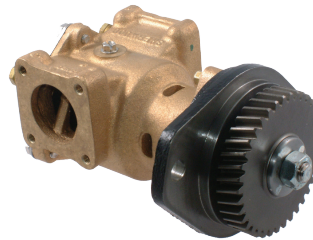

**Model:** P1727C, 3897194  
**Fits:** 300, 350, 400 HP  
**Ports:** Flanged inlet & outlet (Flanges not included).

**Shaft not included with 2110306 major repair kit.**

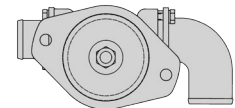

PART NO.	DESCRIPTION	PRICE
2110132	Pump w/Gear	\$1,138.36
2110300	* o Impeller	\$91.72
2110454	* Seal, Mech. "C"	\$126.12
2110455	* o Seal, Mech.	\$49.34
2110674	* o Lip Seal	\$32.21
2110851	* (2) Bearing	\$15.60
2110845	Stainless Steel Shaft	\$352.76
2110849	Threaded Shaft & Bearing	\$257.87
2110571	* Cam	\$93.30
2109945	* o Cover "O" Ring	\$7.97
2110572	Cam Screw	\$9.02
2110642	* End Cover	\$65.44
2110726	End Cover Screw	\$2.21
2110367	* o Key	\$9.80
2110952	*(3) o Retaining Ring	\$11.46
2110772	*(2) Flat Washer	\$8.88
2109946	* O-Ring	\$3.40
2110641	* o Wear Plate	\$63.43
2110759	* Flat Washer	\$2.83
2110305	o Minor Repair Kit	\$328.37
2110304	Minor Repair Kit "C"	\$529.15
2110306	* Major Repair Kit	\$577.79
2110308	Major Repair Kit "C"	\$729.43

\*Inc. in Major Repair Kit, o Included in Minor Repair Kit

**WATER PORTS / FITTINGS FOR P1700 SERIES PUMPS**



2110408



2110409

Water Ports for P1700 series Sherwood pumps.

PART NO.	DESCRIPTION	PRICE
2110400	1-3/4", Straight	\$175.07
2110401	1-3/4", 90°	\$185.77
2110402	2", 45°	\$187.66
2110403	2", 90°	\$195.30
2110408	Water Port O-Ring	\$14.82
2110409	Water Port Bracket	\$39.67

